

60ml infusions made simple! *Easy as...*

1 Wind



Wind large knob until black tab is at end of it's track.

2 Load

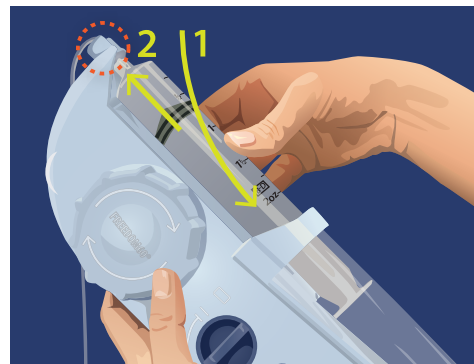

Load prepared syringe.

3 Go

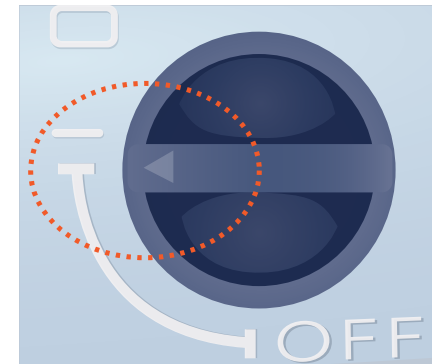

Switch ON *and go!*

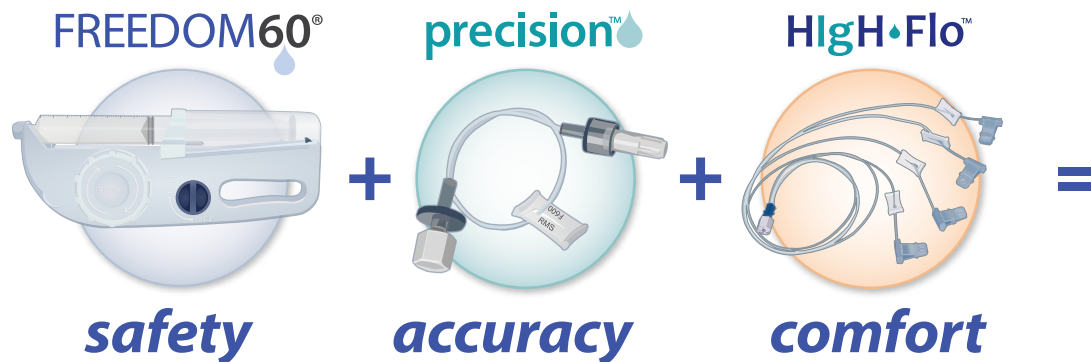

The System

- No batteries, no alarms
- Easy to use & learn
- Safe infusion pressure
- Sub-q & IV use
- Consistent & reliable infusions